

WATERVUE AT BROOKS STREET DEFAULT FLOORPLAN

- Allows all guests to view Sweetheart Table
- Most efficient & comfortable layout for guests
- Separate dessert area for all to view
- Easy to add or take away tables
- Huge dance floor (and/or area for wedding ceremony)

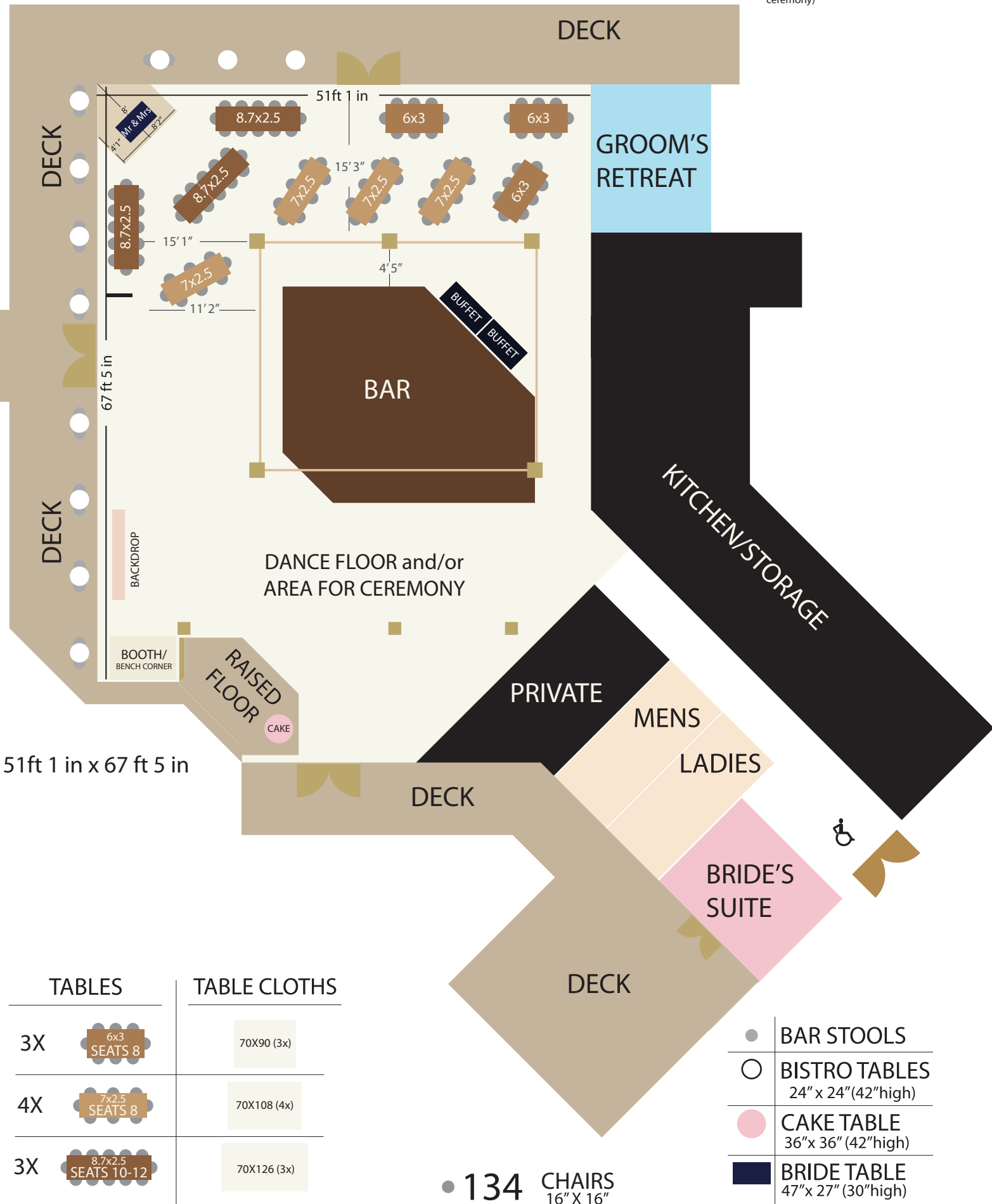

TABLES	
3X	6x3 SEATS 8
4X	7x2.5 SEATS 8
3X	8.7x2.5 SEATS 10-12

TABLE CLOTHS	
	70X90 (3x)
	70X108 (4x)
	70X126 (3x)

● 134 CHAIRS
16" X 16"

●	BAR STOOLS
○	BISTRO TABLES 24" x 24" (42"high)
●	CAKE TABLE 36" x 36" (42"high)
■	BRIDE TABLE 47" x 27" (30"high)