

WATERVUE AT BROOKS STREET FLOORPLAN

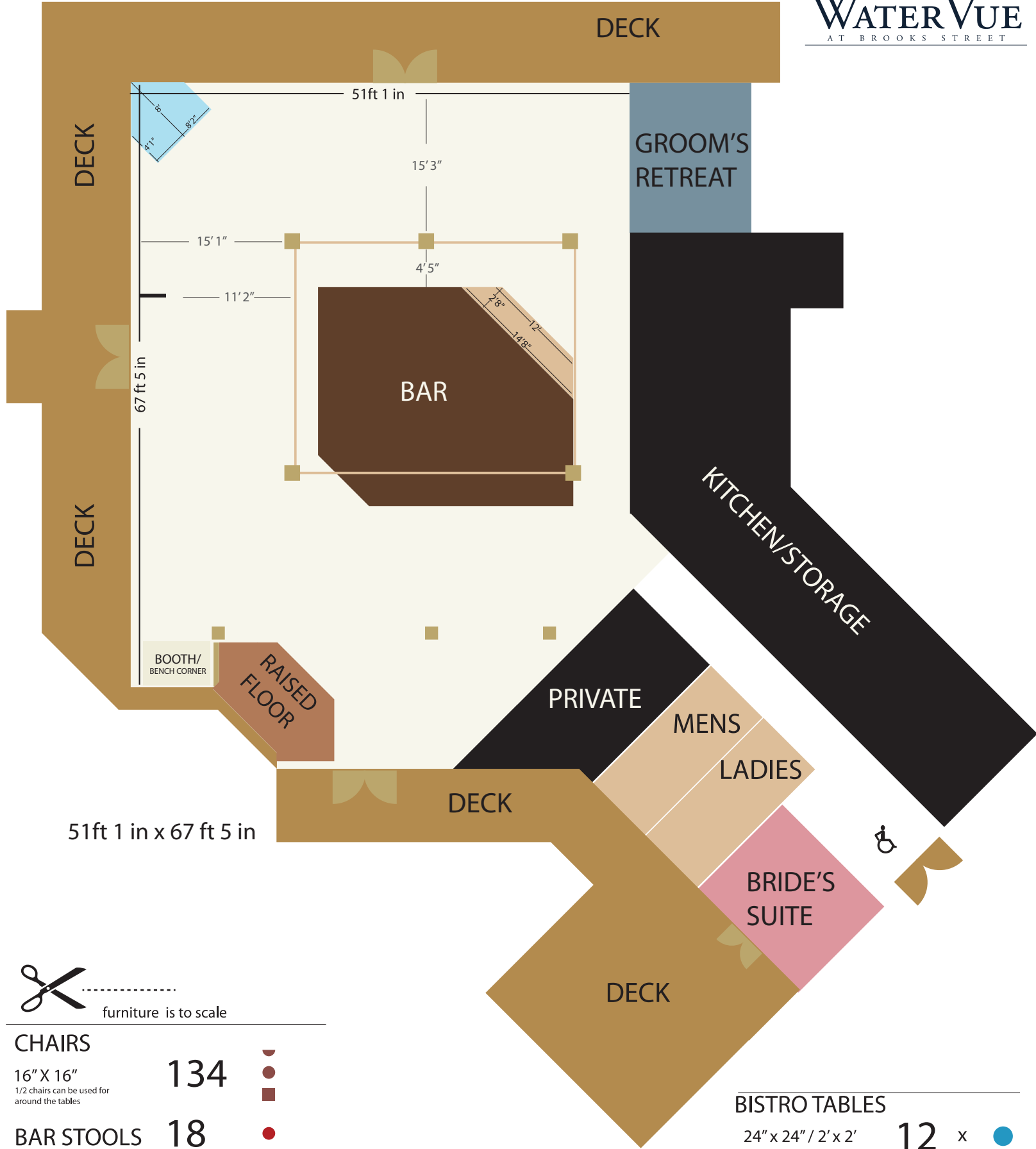

furniture is to scale

CHAIRS
 16" X 16" **134**
1/2 chairs can be used for around the tables

BAR STOOLS **18**

TABLES

36" x 36" / 3' x 3'	16 x	62" x 30" / 5.2' x 2.5'	3 x
42" x 30" / 3.5' x 2.5'	11 x	60" x 30" / 5' x 2.5'	2 x

BISTRO TABLES
 24" x 24" / 2' x 2' **12** x

CAKE TABLE
 36" x 36" (42" high) **1** x

BRIDE TABLE
 47" x 27" (30" high) **1** x